

Discharge bore mm	Phases	Motor output kW	Head max. m	Capacity max. l/min	Max. solid handling ø mm	PH value
2" BSPT	1	0,75	15,0	320	6	5.0-9.0



GENERAL

ø Discharge bore mm	50
Discharge Connection	Threaded flange/Hose coupling

PUMP

COMPONENTS

Impeller	Semi-Vortex impeller
Shaft Seal	Double mechanical seal
Bearings	Shielded ball bearings

MATERIAL

Impeller	Urethane rubber
Casing	Ethylene propylene rubber
Suction Plate	Steelplate+Urethane rubber
Shaft Seal	Silicon carbide in oil bath

PUMPING FLUID

Type of Fluid	Spring water, Rain water, Ground water, Sand carrying water
Temperature	0-40°C

MOTOR

Type, Poles	Induction motor, 2 poles, IP68
Insulation	Insulation class E
Phase / Voltage	Single phase 230V / 110V / 50Hz
Motor Protector (built-in)	Circle thermal cut-out
Lubrication	Turbine oil (ISO VG32)

MATERIAL

Casing	Aluminium die casting
Shaft	Stainless steel EN-X6Cr13
Cable	Rubber, 10m H07RN8-F

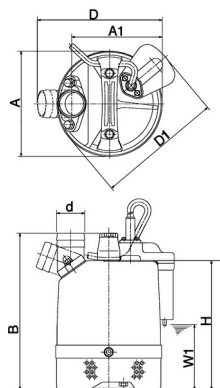

LB-800A

Model	d	A	A1	B	D	D1	H	W1
LB-800A	50	187	160	408	230	223	283	170

In the event of abrasive and corrosive utilization, stronger wear and tear will take place naturally in certain components. In this regard, please pay attention to our website www.tsurumi.eu/english/applications.htm.

Updated 06/2024